



**X5 TYPE--SMD 5X7 CERAMIC PACKAGE**

Standard Specifications

Parameter	Symb	condition	Min	Typ	Max	Unit
Frequency Range	F		1.0		80.0	MHz
Frequency Stability	$\Delta F/F$	Overall	-100		+100	ppm
Operating Temperature Range	0°C to 70°C (-40°C to +85°C available)					
Supply Voltage	V <sub>DD</sub>		4.75	5.00	5.25	V
Input Current	I <sub>DD</sub>	15 pF		12	25	mA
Duty Cycle		@50% V <sub>DD</sub>	40	50	60	%
Rise/Fall Time	T <sub>r</sub> /T <sub>f</sub>	10% to 90%		3.0	5.0	nS
Logic "1" Level	V <sub>oh</sub>	Loaded. Overall	0.9 V <sub>DD</sub>			V
Logic "0" Level	V <sub>ol</sub>	Loaded. Overall			0.1 V <sub>DD</sub>	V
Start-up Time	T <sub>s</sub>			3	10	mS
Enable Input	Input HIGH(>2.2V) or floating: ACTIVE					
Disable Input	Input LOW(<0.8V): INFINITE IMPEDANCE					
Enable/Disable Time					100	nS
Load	10-TTL gates or 15 pF					
Output	HCMOS/TTL					

Ordering Guide

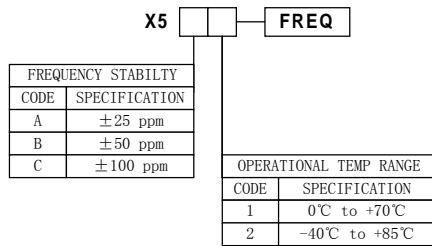

**Example: X5B2-10.000MHz**  
 Frequency stability: ±50ppm  
 Operating Temperature: -40°C to +85°C  
 Frequency: 10.000MHz

**PIN CONNECTIONS**  
 1-N/C or Tristate Control  
 2-GND  
 3-Output  
 4-Supply Voltage

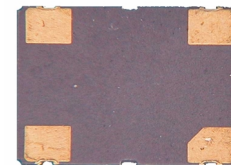
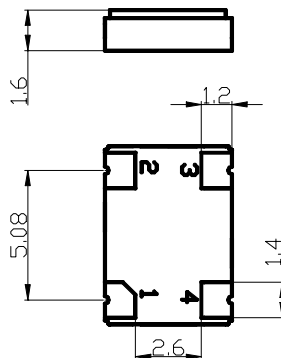
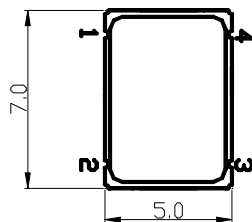

All Dimensions in mm