

X3 TYPE--SMD 5X7 CERAMIC PACKAGE

Standard Specifications

Parameter	Symb	condition	Min	Typ	Max	Unit
Frequency Range	F		1.0		80.0	MHz
Frequency Stability	$\Delta F/F$	Overall	-100		+100	ppm
Operating Temperature Range	0°C to 70°C (-40°C to +85°C available)					
Supply Voltage	V _{DD}		3.15	3.30	3.45	V
Input Current	I _{DD}	15 pF		12	25	mA
Duty Cycle		@50% V _{DD}	40	50	60	%
Rise/Fall Time	T _r /T _f	10% to 90%		3.0	5.0	nS
Logic "1" Level	V _{oh}	Loaded. Overall	0.9 V _{DD}			V
Logic "0" Level	V _{ol}	Loaded. Overall			0.1 V _{DD}	V
Start-up Time	T _s			3	10	mS
Enable Input	Input HIGH(>2.2V) or floating: ACTIVE					
Disable Input	Input LOW(<0.8V): INFINITE IMPEDANCE					
Enable/Disable Time					100	nS
Load	10-TTL gates or 15 pF					
Output	HCMOS/TTL					

Ordering Guide

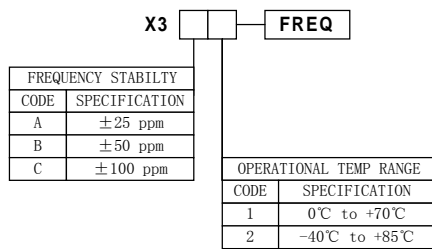

Example: X3B1-25.000MHz
 Frequency stability: ±50ppm
 Operating Temperature: 0°C to +70°C
 Frequency: 25.000MHz

PIN CONNECTIONS
 1-N/C or Tristate Control
 2-GND
 3-Output
 4-Supply Voltage

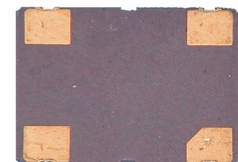
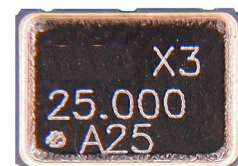
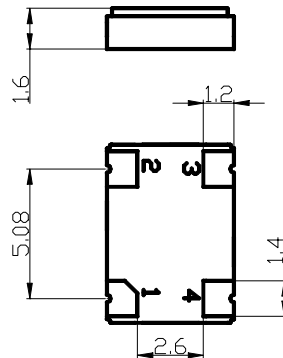
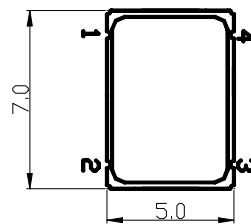

All Dimensions in mm